

All dimensions are to be checked on site.
Do not scale from this drawing
Use written dimensions only.

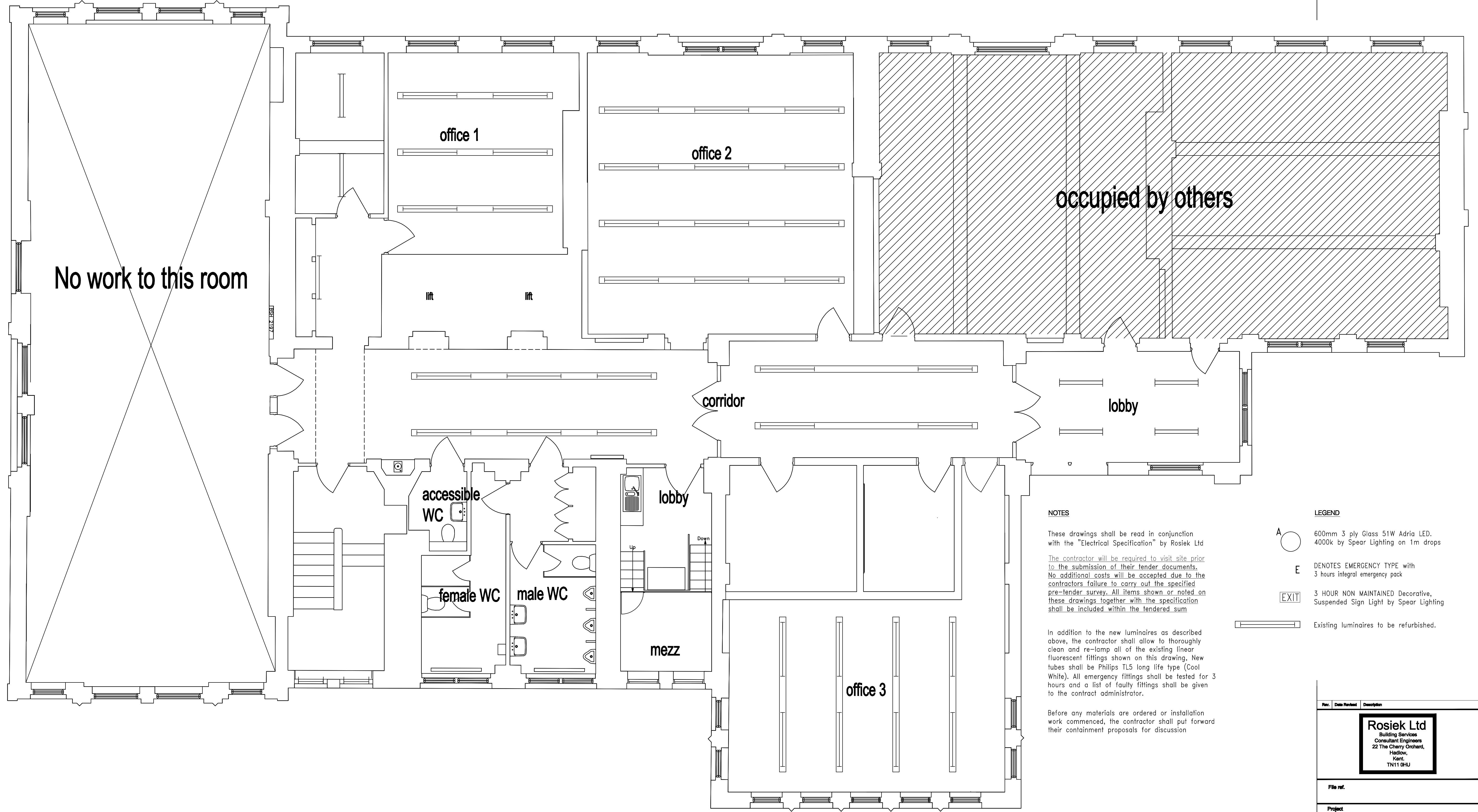

occupied by others

No work to this room

corridor

lobby

lobby

mezz

office 3

office 1

office 2

accessible
WC

female WC

male WC

NOTES

These drawings shall be read in conjunction with the "Electrical Specification" by Rosiek Ltd

The contractor will be required to visit site prior to the submission of their tender documents. No additional costs will be accepted due to the contractors failure to carry out the specified pre-tender survey. All items shown or noted on these drawings together with the specification shall be included within the tendered sum

In addition to the new luminaires as described above, the contractor shall allow to thoroughly clean and re-lamp all of the existing linear fluorescent fittings shown on this drawing. New tubes shall be Philips TL5 long life type (Cool White). All emergency fittings shall be tested for 3 hours and a list of faulty fittings shall be given to the contract administrator.

Before any materials are ordered or installation work commenced, the contractor shall put forward their containment proposals for discussion

LEGEND

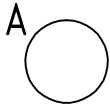

600mm 3 ply Glass 51W Adria LED.
4000k by Spear Lighting on 1m drops

E

DENOTES EMERGENCY TYPE with
3 hours integral emergency pack

EXIT

3 HOUR NON MAINTAINED Decorative,
Suspended Sign Light by Spear Lighting

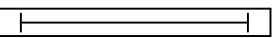

Existing luminaires to be refurbished.

Rev.	Date Revised	Description
<div><div><div>Rosiek Ltd</div><div>Building Services Consultant Engineers 22 The Cherry Orchard, Hadlow, Kent. TN11 0HU</div></div></div>		
File ref.		
Project Laycock Centre		
Drawing Title Proposed First Floor Lighting		
Client London Borough of Islington		
Drawing Status Tender		Checked/Approved bj
Scale 1:50	Paper Size A1	Drawn PG Date Drawn 01.09.20
Drawing No. 20090 - P - 202		Revision