

- Notes:**
1. This drawing is based on survey information by Global Surveys. Measured Building Survey. Dated Dec 2017. Provided by Hertfordshire Constabulary Nov 2021
 2. Existing vertical timber trims along walls and wall paper in core to be stripped.
 3. Infill openings above doors (all around core)
 4. New partitions constructed off raised floors with cavity barriers below but all extend through suspended ceilings.
 5. Refix existing timber stair edgings at all levels and replace where missing to match existing

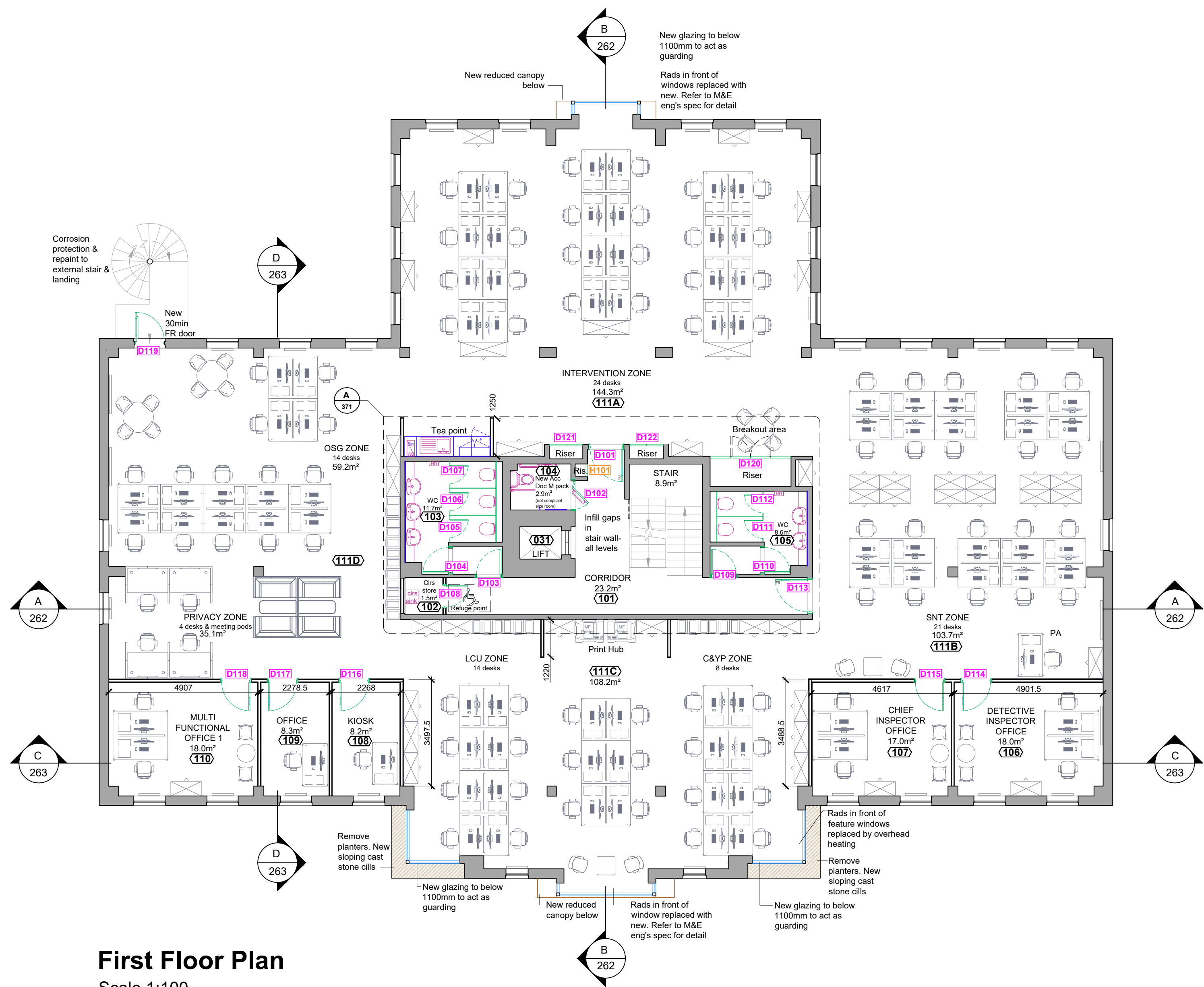

First Floor Plan
Scale 1:100
GIFA: 608m²

KEY	
	New partitions, spec. K10/115
	New Taser room wall, spec. K10/120
	New blockwork partition
	New doors, spec. L10/L20
	New glass, spec. L10
	New sanitary, spec. N13
	New fixed furniture, spec. N10
	Additional layer of Plasterboard with acoustic lining above dado
	Security access Control
	Automatic Powered Doors
	New Door numbers
	Room Number
	Riser Hatch number

D	PRELIM - TENDER ISSUE	22.04.22	JP
C	DRAFT - TENDER ISSUE - SNT zone furniture layout updated. WC cubicle walls replaced.	31.03.22	JP
B	DRAFT - TENDER ISSUE - Furniture layout updated	09.03.22	JP
A	DRAFT - TENDER ISSUE	01.03.22	JP
REV	DESCRIPTION	DATE	BY

WATFORD POLICE STATION
3 GEORGE STREET
WATFORD WD18 0BX

Proposed
First Floor Plan

VGA PROJECT NUMBER		L&L
7664		
DRAWING NO		REV
WPS-VGA-GS-01-DR-A-00 252		D
DRAWN / DATE	CHECKED / DATE	SCALE
CB / FEB 22	AR / FEB 22	1:100 at A1

PRELIMINARY

Written dimensions to be taken. Do not scale off the drawings. Any discrepancies written or scaled should be brought to the attention of the architect immediately. All drawings should be read together and in conjunction with relevant related specifications, room data sheets and all other consultant's information.

T: +44 (0) 1438 316 331
architects@vincent-gorbing.co.uk
vincent-gorbing.co.uk

Vincent and Gorbing Limited, Sterling Court
Norton Road, Stevenage, Hertfordshire SG1 2JY
© Copyright Vincent and Gorbing Limited 2020

